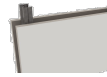

**IN-CO** Avec vis à tête bombée

Matériaux utilisés:

CREUX

Placo-prâtre

Béton
creuseBrique
creuse

Matériau du produit / Revêtement:

Zingué

BOÎTE PROFESSIONNELLE

CODE	MESURES			EAN	RIX
INCO421	M4 x 30 Ø 8	100 pcs.	2400 pcs.	8423533076335	18,278
INCO432	M4 x 41 Ø 8	100 pcs.	1200 pcs.	8423533076373	19,747
INCO438	M4 x 47 Ø 8	100 pcs.	1200 pcs.	8423533080943	22,272
INCO446	M4 x 53 Ø 8	100 pcs.	1200 pcs.	8423533076397	23,897
INCO459	M4 x 67 Ø 8	100 pcs.	1200 pcs.	8423533076427	37,65
INCO537	M5 x 46 Ø 10	100 pcs.	1200 pcs.	8423533076441	28,941
INCO552	M5 x 59 Ø 10	100 pcs.	600 pcs.	8423533076489	33,394
INCO565	M5 x 72 Ø 10	100 pcs.	600 pcs.	8423533076519	40,063
INCO580	M5 x 89 Ø 10	100 pcs.	600 pcs.	8423533076533	48,972
INCO637	M6 x 46 Ø 12	100 pcs.	1200 pcs.	8423533076571	42,3
INCO652	M6 x 59 Ø 12	100 pcs.	600 pcs.	8423533076595	42,588
INCO665	M6 x 72 Ø 12	100 pcs.	600 pcs.	8423533076625	50,166
INCO680	M6 x 89 Ø 12	100 pcs.	600 pcs.	8423533076649	72,634

BLISTER



CODE	MESURES	QUANTITÉ	SACS	EAN	QUANTITÉ	EAN	PRIX
BZINCO432	M4 x 41 Ø 8	40 pcs.	20 sacs	8423533430274	2pcs.	8423533422620	2,58
BZINCO438	M4 x 47 Ø 8	40 pcs.	20 sacs	8423533430281	2pcs.	8423533422637	2,58
BZINCO537	M4 x 53 Ø 8	40 pcs.	20 sacs	8423533430298	2pcs.	8423533422644	2,58
BZINCO552	M5 x 46 Ø 10	30 pcs.	15 sacs	8423533430304	2pcs.	8423533422651	2,58
BZINCO565	M5 x 59 Ø 10	30 pcs.	15 sacs	8423533430311	2pcs.	8423533422668	2,58
BZINCO637	M6 x 46 Ø 12	30 pcs.	15 sacs	8423533430328	2pcs.	8423533422675	2,58
BZINCO652	M6 x 59 Ø 12	30 pcs.	15 sacs	8423533430335	2pcs.	8423533422682	2,58

BOÎTE À FENÊTRE



CODE	MESURES	QUANTITÉ	SACS	EAN	QUANTITÉ	EAN	PRIX
VINCO432	M4 x 41 Ø 8	120 pcs.	8 sacs	8423533053831	15pcs.	8423533754479	5,466
VINCO438	M4 x 47 Ø 8	120 pcs.	8 sacs	8423533053848	15pcs.	8423533754486	5,939
VINCO446	M4 x 53 Ø 8	120 pcs.	8 sacs	8423533053855	15pcs.	8423533754493	6,46
VINCO537	M5 x 46 Ø 10	120 pcs.	8 sacs	8423533053862	15pcs.	8423533754509	7,502
VINCO552	M5 x 59 Ø 10	96 pcs.	8 sacs	8423533053916	12pcs.	8423533754516	6,435
VINCO637	M6 x 46 Ø 12	80 pcs.	8 sacs	8423533053923	10pcs.	8423533754523	5,702
VINCO652	M6 x 59 Ø 12	80 pcs.	8 sacs	8423533053930	10pcs.	8423533754530	6,622

LIBRE SERVICE



CODE	MESURES	QUANTITÉ	SACS	EAN	QUANTITÉ	EAN	PRIX
LSINCO432	M4 x 41 Ø 8	180 pcs.	6 sacs	8423533408419	30pcs.	8423533761033	9,746
LSINCO438	M4 x 47 Ø 8	180 pcs.	6 sacs	8423533408402	30pcs.	8423533761040	10,588
LSINCO446	M4 x 53 Ø 8	180 pcs.	6 sacs	8423533408426	30pcs.	8423533771766	11,517
LSINCO537	M5 x 46 Ø 10	150 pcs.	6 sacs	8423533408396	25pcs.	8423533761057	11,148
LSINCO552	M5 x 59 Ø 10	126 pcs.	7 sacs	8423533408433	18pcs.	8423533772862	8,607
LSINCO637	M6 x 46 Ø 12	140 pcs.	7 sacs	8423533408389	20pcs.	8423533761132	10,168
LSINCO652	M6 x 59 Ø 12	105 pcs.	7 sacs	8423533408372	15pcs.	8423533761149	8,858

INFORMATION TECHNIQUE

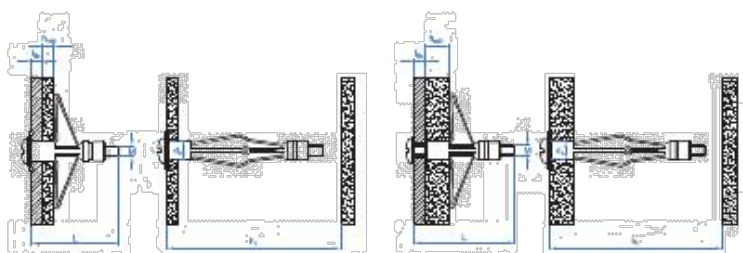

CODE	MESURES	Foret	Épaisseur du matériau de base	Épaisseur max. à fixer	Extraction placo-plâtre	Extraction plâtre
INCO421	M4 x 30 Ø 8	8	1-5	17 -hmin	20	20
INCO432	M4 x 41 Ø 8	8	3-10	22 -hmin	20	20
INCO438	M4 x 47 Ø 8	8	9-16	30 -hmin	20	20
INCO446	M4 x 53 Ø 8	8	15-22	33 -hmin	20	20
INCO459	M4 x 67 Ø 8	8	31-36	52 -hmin	20	20
INCO537	M5 x 46 Ø 10	10	5-14	26 -hmin	20	25
INCO552	M5 x 59 Ø 10	10	6-18	42 -hmin	20	30
INCO565	M5 x 72 Ø 10	10	16-33	55 -hmin	20	30
INCO580	M5 x 89 Ø 10	10	33-46	61 -hmin	20	30
INCO637	M6 x 46 Ø 12	12	5-13	25 -hmin	15	20
INCO652	M6 x 59 Ø 12	12	6-17	38 -hmin	20	25
INCO665	M6 x 72 Ø 12	12	14-32	49 -hmin	20	25
INCO680	M6 x 89 Ø 12	12	34-46	78 -hmin	20	25
BZINCO432	M4 x 41 Ø 8	8	3-10	22 -hmin	20	20
BZINCO438	M4 x 47 Ø 8	8	9-16	30 -hmin	20	20
BZINCO537	M4 x 53 Ø 8	8	15-22	33 -hmin	20	25
BZINCO552	M5 x 46 Ø 10	10	5-14	26 -hmin	20	30
BZINCO565	M5 x 59 Ø 10	10	6-18	42 -hmin	20	30
BZINCO637	M6 x 46 Ø 12	12	5-13	25 -hmin	15	20
BZINCO652	M6 x 59 Ø 12	12	6-17	38 -hmin	20	25
VINCO432	M4 x 41 Ø 8	8	3-10	22 -hmin	20	20
VINCO438	M4 x 47 Ø 8	8	9-16	30 -hmin	20	20
VINCO446	M4 x 53 Ø 8	8	15-22	33 -hmin	20	20
VINCO537	M5 x 46 Ø 10	10	5-14	26 -hmin	20	25
VINCO552	M5 x 59 Ø 10	10	6-18	42 -hmin	20	30
VINCO637	M6 x 46 Ø 12	12	5-13	25 -hmin	15	20
VINCO652	M6 x 59 Ø 12	12	6-17	38 -hmin	20	25

LSINCO432	M4 x 41 Ø 8	8	3-10	22 -hmin	20	20
LSINCO438	M4 x 47 Ø 8	8	9-16	30 -hmin	20	20
LSINCO446	M4 x 53 Ø 8	8	15-22	33 -hmin	20	20
LSINCO537	M5 x 46 Ø 10	10	5-14	26 -hmin	20	25
LSINCO552	M5 x 59 Ø 10	10	6-18	42 -hmin	20	30
LSINCO637	M6 x 46 Ø 12	12	5-13	25 -hmin	15	20
LSINCO652	M6 x 59 Ø 12	12	6-17	38 -hmin	20	25

CARACTÉRISTIQUES



Zingué



Faibles



Ph

RECOMMANDÉ POUR



Collier lampe

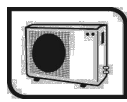

Climatisation



Fixation extincteur

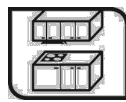

Placard cuisine

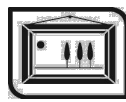

Tableau

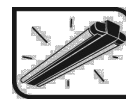

Fluorescent



Lampe de plafond

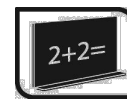

Tableau

TECHNIQUES DOCUMENTS



FICHE TECHNIQUE

<https://www.indexfix.com/docs/ft-inde-fr.pdf>

*Les données présentées dans ce tableau sont pour information seulement et ne constituent en aucun cas, les conditions contractuelles d'approvisionnement. Les références à notre catalogue seront disponibles jusqu'à épuisement des stocks.

Nos tarifs n'incluent pas les taxes indirectes sur la valeur ajoutée. Ils seront taxés conformément aux normes en vigueur dans les transactions nationales et internationales.